

John Calhoon's heirs.

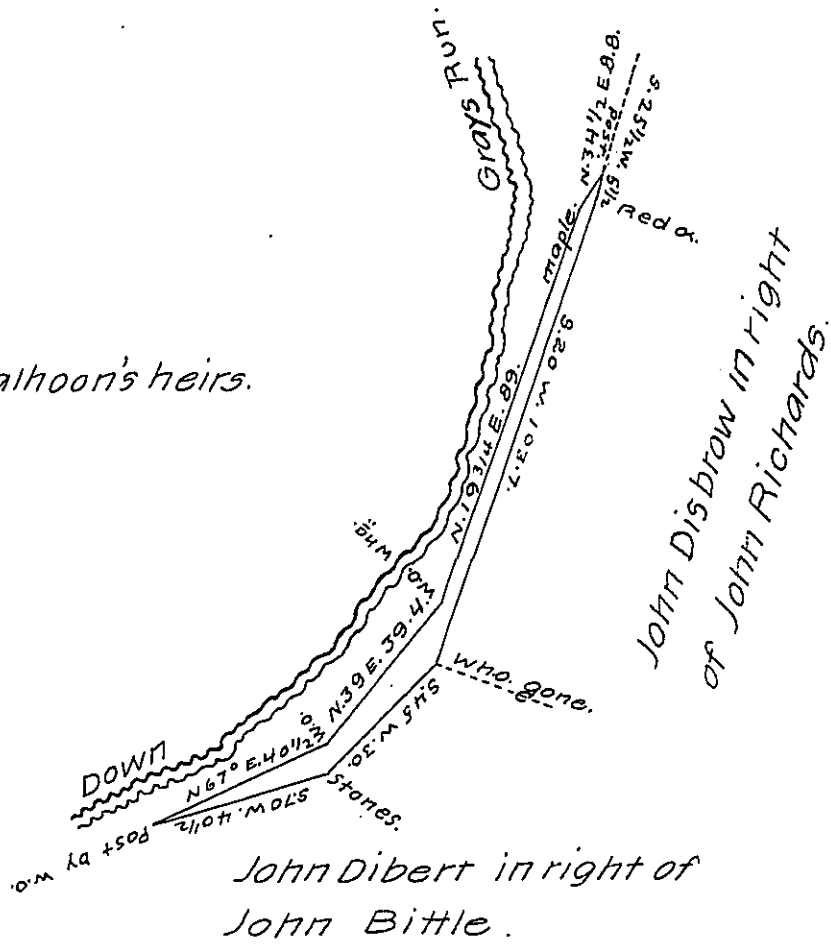

John Dibert in right of John Bittle.

Situate near Greys Run in West Providence Township, Bedford County Containing 1 acre, 139 perches and the usual allowance of Six pr. Cent for Roads &c. Surveyed by Solomon Williams the 26<sup>th</sup>. day of June, 1874. On Warrant granted to David Calhoon dated the 27<sup>th</sup>. day of February, 1874.

Examined and approved  
the 19<sup>th</sup>. day of the 11<sup>th</sup>. moth. (Novr.) 1874

By Hiram Blackburn, C.S.

To Robt B. Beath, S.G.

IN TESTIMONY that the above is a copy of the original remaining on file in the Department of Internal Affairs of Pennsylvania, made conformably to an Act of Assembly approved the 16th day of February, 1833, I have hereunto set my Hand and caused the Seal of said Department to be affixed at Harrisburg, this twenty eighth day of November, 1906

*Hiram Blackburn*  
Secretary of Internal Affairs.